

Setting up VPN on iOS/iPadOS



**Hochschule
Hof**

University of
Applied Sciences

If you have any questions, please contact IT support:

Tel.: 09281 409 3666

E-Mail: it-servicedesk@hof-university.de





Content

Installing and configuring FortiClient

3

Setting up a VPN connection

7

Installing and configuring FortiClient



- open the **App Store**
- download **FortiClient**

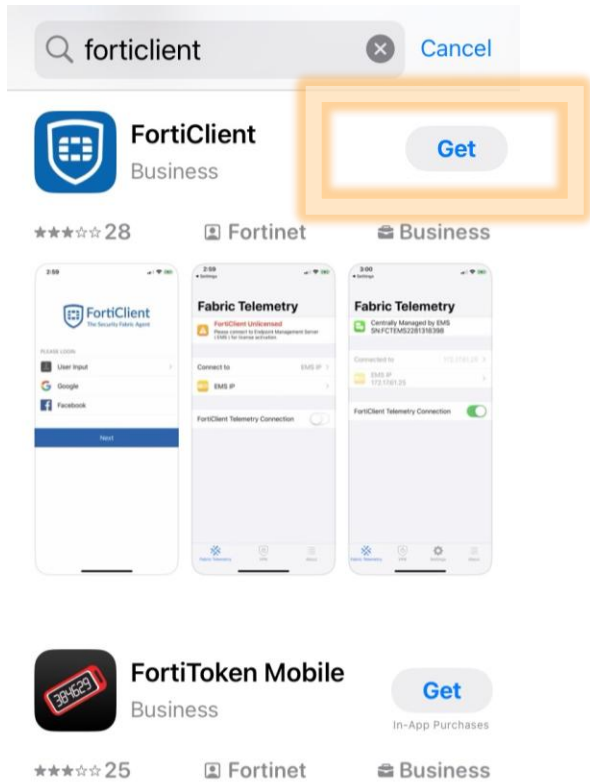

- **allow** the VPN configuration

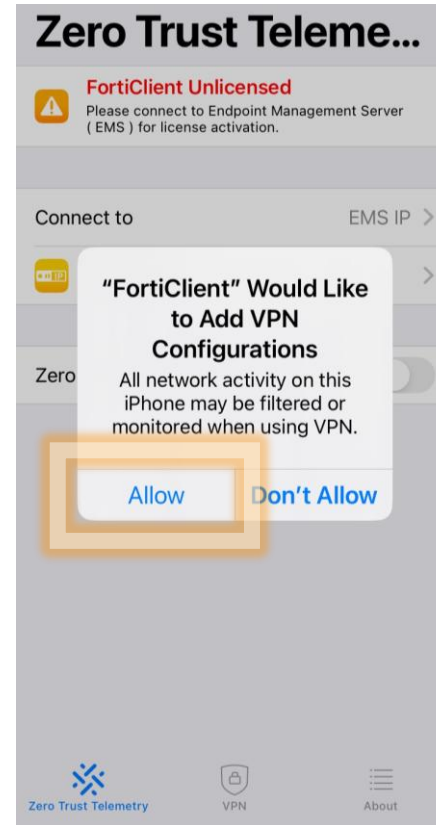

- select **Allow**

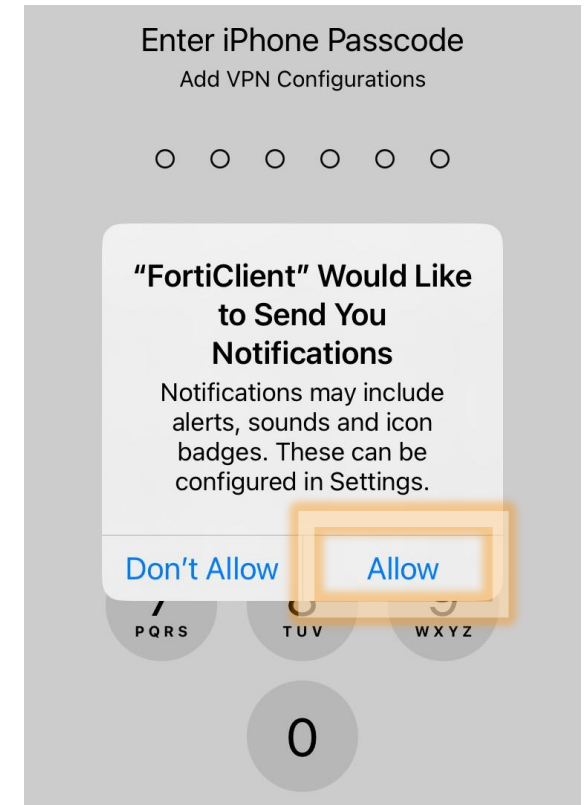

Installing and configuring FortiClient



- choose **I accept**

Privacy Policy Highlights

FortiClient DOES NOT collect any user specific personal information like username, photos or email address and send to Fortinet.



Analytics

FortiClient may collect anonymous usage information and share with Fortinet for the purpose of improving usability and functionality.



VPN

FortiClient does not monitor end user VPN traffic.



WebFilter

FortiClient webfilter feature, if enabled, submits website urls to Fortinet servers for category rating.

By selecting "I accept" below, you agree to the FortiClient [Terms of Service](#) and [Privacy Policy](#).

I accept

- choose **Next**



PLEASE LOGIN



User Input



Google



Sign in with Apple

Next

- tap on **Select connection**

VPN

Connection

Select connection >

Connect



Status

Disconnected

Installing and configuring FortiClient



- choose **Add Configuration**

< **Select VPN Connection** Edit

+ Add Configuration >

Scan QR Code to add VPN >

< Back Hochschule Hof Save

VPN ACCOUNT INFORMATION

Secure Protocol SSLVPN

Name Hochschule Hof

Server Address https://vpn.hof-univ...

Add Server Address +

SSO

Port 443

CLIENT CERTIFICATE

Use Certificate

CREDENTIALS

Username mmustermann

The following information must be added:

- **Secure Protocol**
SSLVPN
- **Name**
Hochschule Hof
- **Server Address**
vpn.hof-university.de
- **Port**
443
- **Username**
Your university username, e.g.
mmustermann

Installing and configuring FortiClient



- choose **Hochschule Hof**

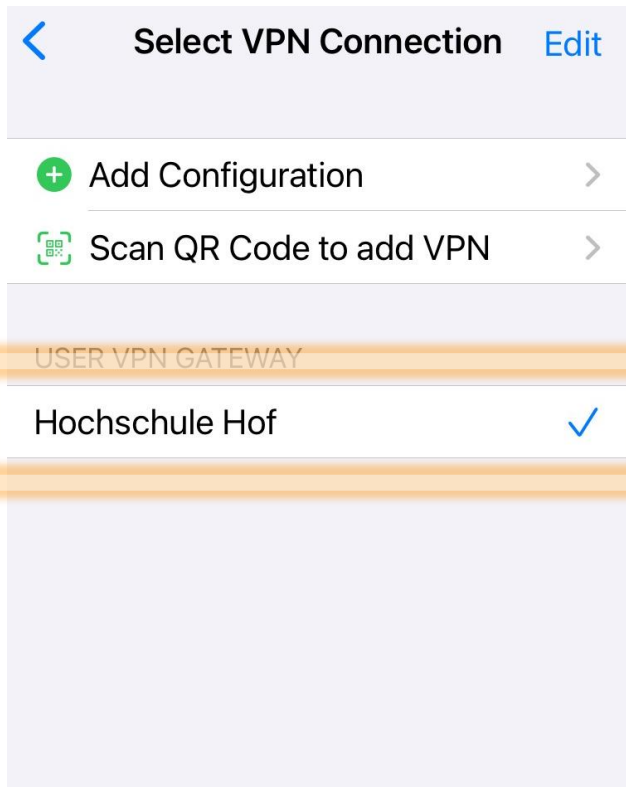

- tap on **About**
- choose **Advanced Settings**

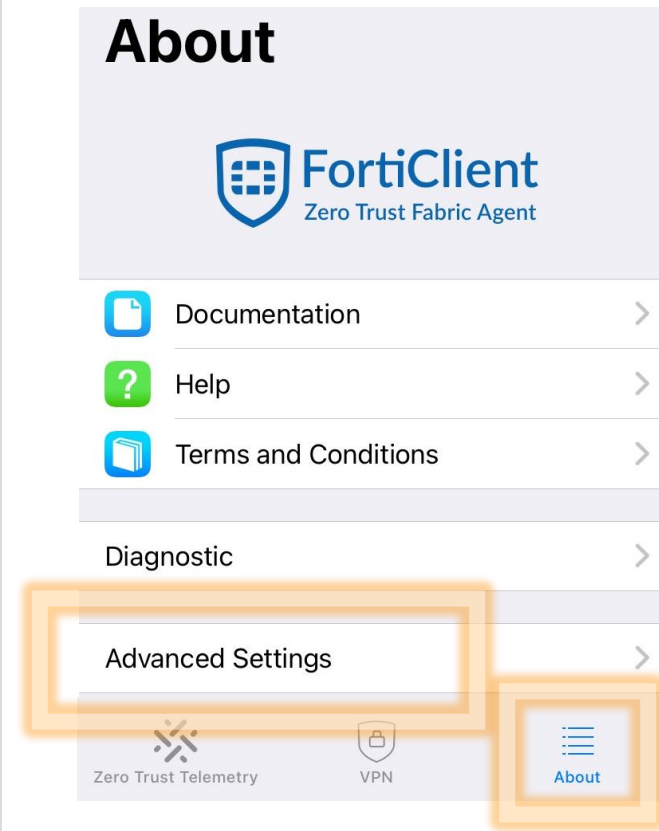

- switch on the **preferred DTLS tunnel**

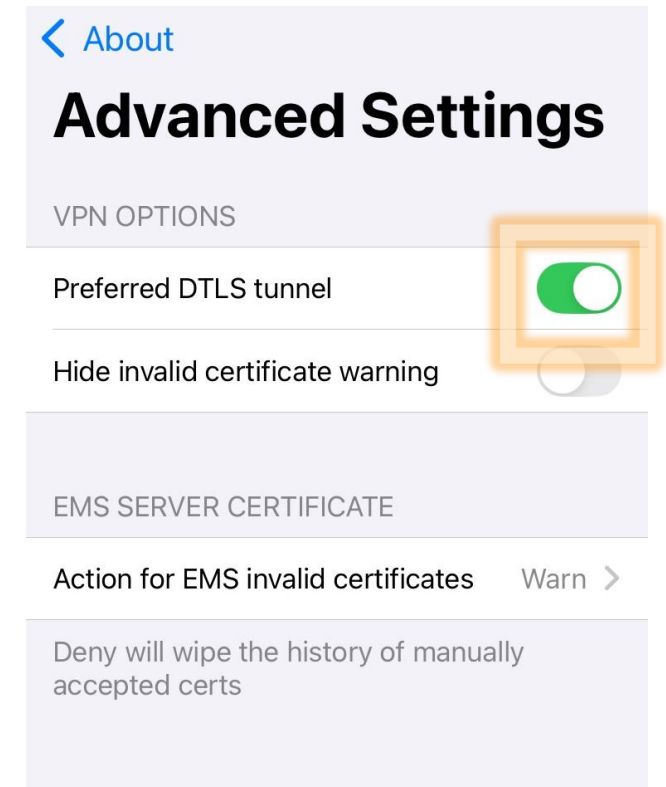

Setting up a VPN connection



- tap **VPN** below

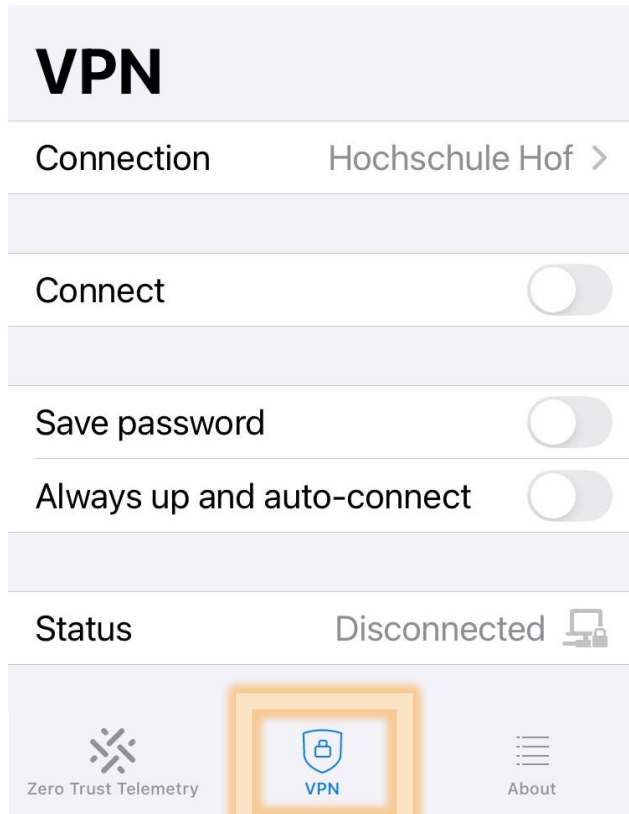

- switch on the **Connect**

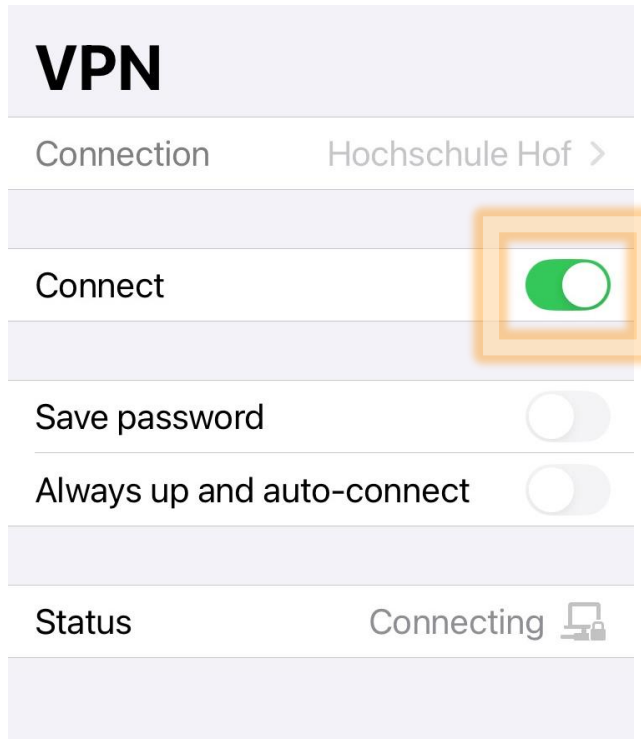

- use **your login data (username, password)**

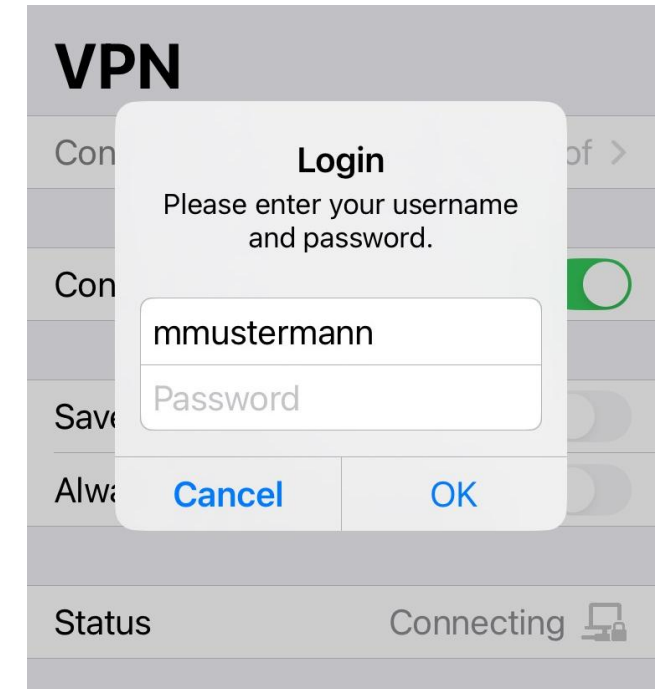

Setting up a VPN connection



- open **Microsoft Authenticator**

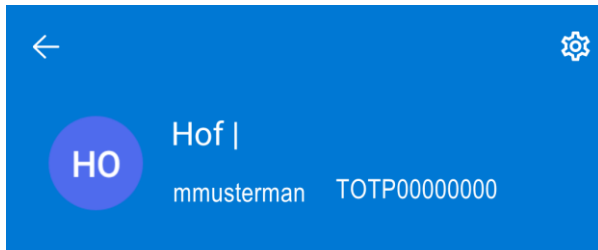

Einmalkennwörter aktiviert

Sie können die von dieser App generierten Codes für Einmalkennwörter verwenden, um Ihre Anmeldungen zu verifizieren.

Code für Einmalkennwort

28 277 672

- copy and paste **your OTP for Moodle/SSO**

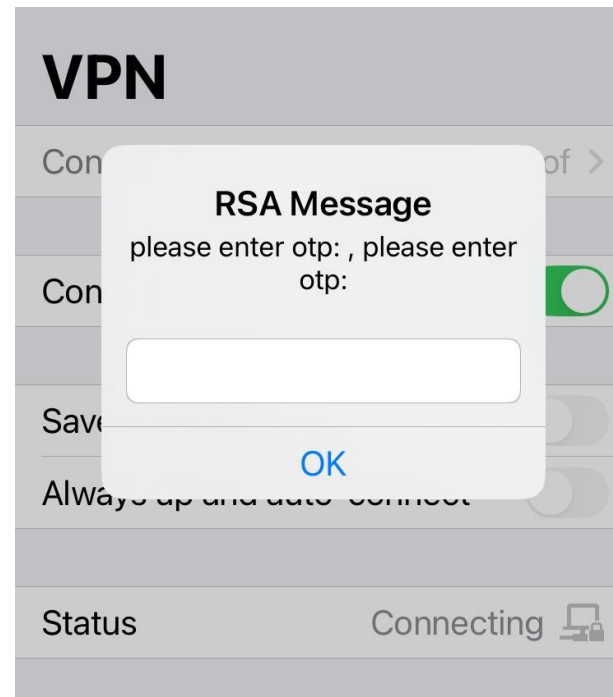

- switch on the **Connect if necessary**

